

SOLD



June Wheeler
RE/MAX United Vision



11 Springvale Place, Carina

This delightfully presented and excellently maintained lowset home has been solidly constructed by a reputable, well-known local builder, Joe Fetini. Situated in a whisper quiet position in a much sought-after brick estate, only one house off park, a perfect "no worries" lifestyle is on offer here. The home features a lovely, light and bright, welcoming ambience throughout its spacious interior. An ideal indoor/outdoor flow onto the ultra-private alfresco area and easy care gardens completes the idyllic picture. Boasting an extremely realistic price tag, a golden opportunity is on offer here! There is nothing to do but sit back, relax and enjoy the fruits of life!! A separate entry opens onto the charming formal living area. Expect to be pleasantly surpr...

4  2  2 

Price: \$655,000

View: <https://remaxunitedvision.com.au/4907563>

June Wheeler
M 0413 125 725



RE/MAX United Vision,
Carina

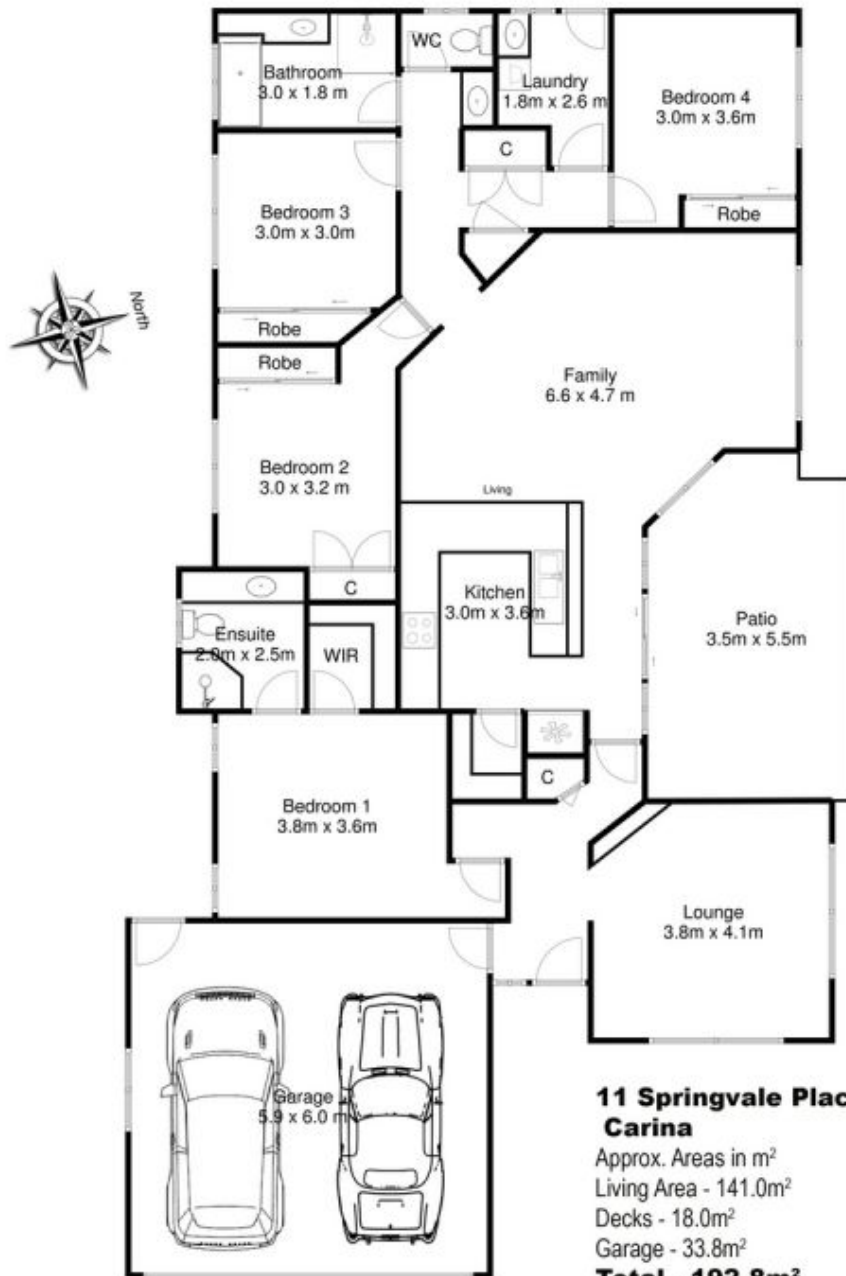

**11 Springvale Place,
Carina**

Approx. Areas in m²
 Living Area - 141.0m²
 Decks - 18.0m²
 Garage - 33.8m²
Total - 192.8m²



Whilst every attempt has been made to ensure the accuracy of this floor plan, all measurements shown or implied are approximate and no responsibility is taken for any error, or omission, nor is any warranty given. Kitchen, bathrooms, appliances, fixtures, fittings or any other items shown are representative only, and do not necessarily match what is in the property. Different levels may not align correctly. These plans are for illustrative purposes only and should be used as such. Copyright 2019. All rights reserved - www.realestateplans.com.au